



VDD CONTROL
DUAL TONE

電源控制
128 音符雙音 IC

MELODY	
M994A	

FEATURES 功能敘述

- Dual tone 128 notes.
- OL : Switch of one octave lower output.
- Package : TO92-3L.

P/N	SONG LIST
M994A-05L	SWEET HOME
M994A-19L	FOR ALICE
M994A-68L	SMALL WORLD (18 Sec)
M994A-69L	SMALL WORLD (14 Sec)
M994A-LBL	LOVE BLUE

APPLICATION 產品應用

- Telephone, EPABX, Toys etc..

ELECTRICAL CHARACTERISTICS 電氣規格

(@V_{DD}=3V unless otherwise specified)

Characteristics	Sym.	Min.	Typ.	Max.	Unit	REMARKS
工作電壓 Operating Voltage	V _{DD}	—	3	3.5	V	
工作電流 Operating Current	I _{OP}	—	0.4	0.7	mA	No load
靜態電流 Quiescent Current	I _{SB}	—	—	—	μA	
推動電流 BZ Driving Current	I _O	0.4	0.7	—	mA	@V _{DS} =1V
推動電流 LED Driving Current	I _{OL}	6	6	—	mA	@V _{DS} =1.2V
振盪頻率 Oscillator Frequency	F _{OSC}	—	250	—	KHz	±30% TOL.
工作溫度 Operating Temperature	Temp.	0	25	60	°C	

APPLICATION DIAGRAM 參考電路圖

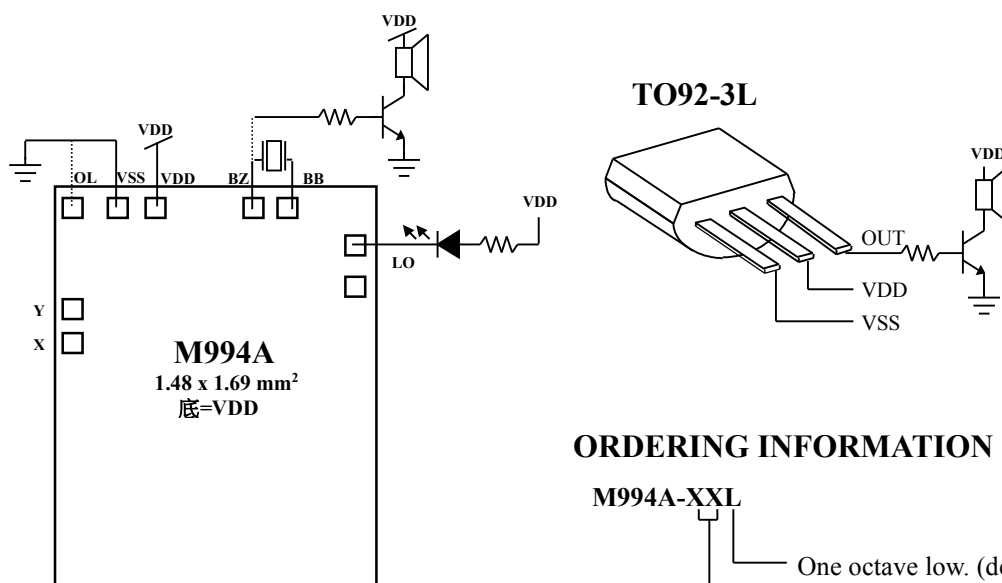

ORDERING INFORMATION

M994A-XXL
 One octave low. (default Normal)
 Song Name

*All specs and applications shown above subject to change without prior notice.
(以上電路及規格僅供參考,本公司得逕行修正)



VDD CONTROL
DUAL TONE

電源控制
128 音符雙音 IC

MELODY	
M994A	

PACKAGE OUTLINE

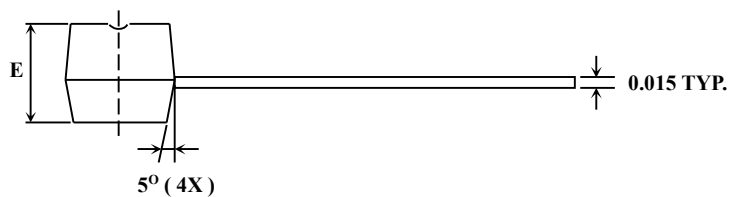
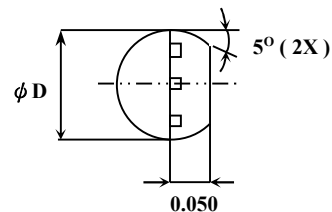
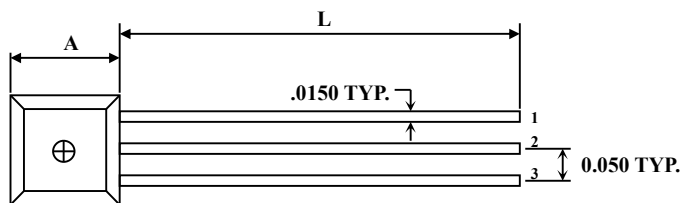

SYMBOLS	MIN	NOR.	MAX
A	.170	.180	.210
ϕD	.175	.180	.205
E	.125	.142	.165
L	.500	.580	

UNIT : INCH

TO-92-L3